

MODULAR SYSTEMS | PARTITIONS | STORAGES

Non Sharing Work Station



Sharing Work Station



L Shape Work Station



Cluster Work Station



Reception Tables

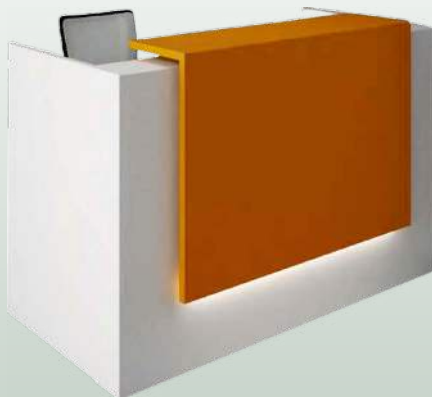

Manager Tables



Conference Tables



Storage / Pedestals



Desk - Evo 01

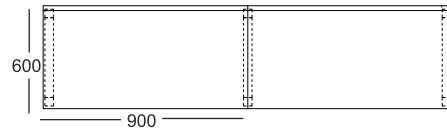

Single Side (linear) workstation
 1200/1050/900 X 600mm
 CRCA Powder coated under
 structure
 CRCA Powder coated raceway
 32mm/ 45mm screen/ 8 mm
 lacquered glass screen
 side divider glass/ partition based



Desk - Evo 02



ARCHMATE®

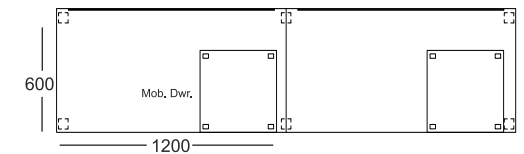

Single Side (linear) workstation
 1200/1050/900 X 600mm
 CRCA Powder coated under
 structure
 CRCA Powder coated raceway
 32mm/ 45mm screen/ 8 mm
 lacquered glass screen
 with mobile drawer
 side divider glass/ partition based



Desk - Evo 03

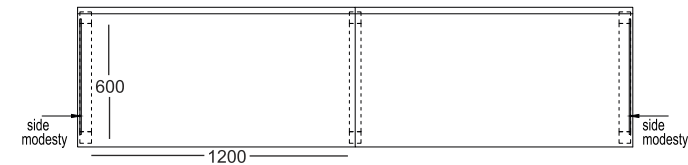

Single Side (linear) workstation
1200/1050/900 X 600mm
CRCA Powder coated under
structure
CRCA Powder coated raceway
32mm/ 45mm screen/ 8 mm
lacquered glass screen
side divider glass/ partition based

Desk - Evo 04

Single Side (linear) workstation
1200/1050/900 X 600mm
CRCA Powder coated under
structure
CRCA Powder coated raceway
32mm/ 45mm screen/ 8 mm
lacquered glass screen
side divider glass/ partition based



ARCHMATE®





Part - Evo 01

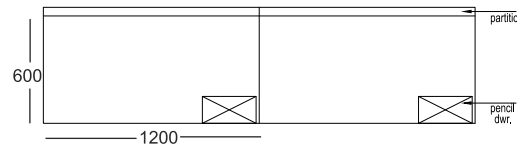

Single Side (linear) workstation
1200/1050/900 X 600mm
Aluminum Powder coated raceway
45mm/60mm screen partition with
fabric / white marker board
with pencil drawer
side divider glass/ partition based



Part - Evo 02

Single Side (linear) workstation
1200/1050/900 X 600mm
Aluminum Powder coated raceway
45mm/60mm screen partition with fabric /
white marker board
with mobile drawer
side divider glass/ partition based

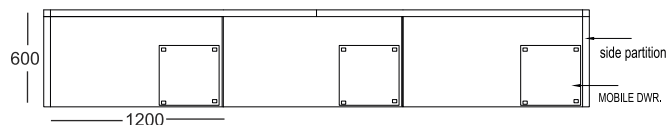

Part - Evo 03

Single Side (linear) workstation
1200/1050/900 X 600mm
Aluminum Powder coated raceway
45mm/60mm screen partition with
fabric / white marker board
with mobile drawer
side divider glass/ partition based

ARCHMATE®

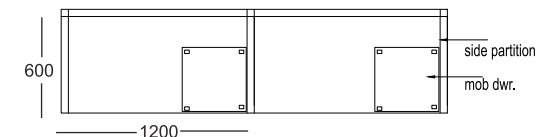

Desk - Pro 01

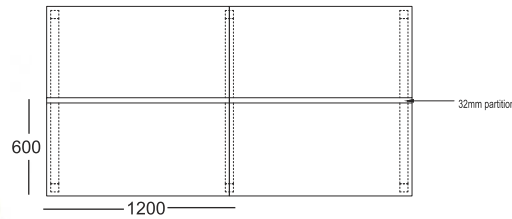

Back to back workstation
1200/1050/900 X 600mm
CRCA Powder coated under structure
CRCA Powder coated raceway
32mm/ 45mm screen/ 8 mm
lacquered glass screen
side divider glass/ partition based

Desk - Pro 02



ARCHMATE®

Desk - Pro 03

Back to back workstation
1200/1050/900 X 600mm
CRCA Powder coated under structure
CRCA Powder coated raceway
32mm/ 45mm screen/ 8 mm lacquered
glass screen
side divider glass/ partition based

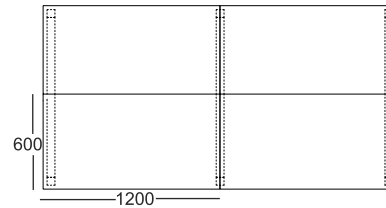

Back to back workstation
1200/1050/900 X 600mm
CRCA Powder coated under structure
CRCA Powder coated raceway
32mm/ 45mm screen/ 8 mm lacquered glass
screen
with mobile drawer
side divider glass/ partition based

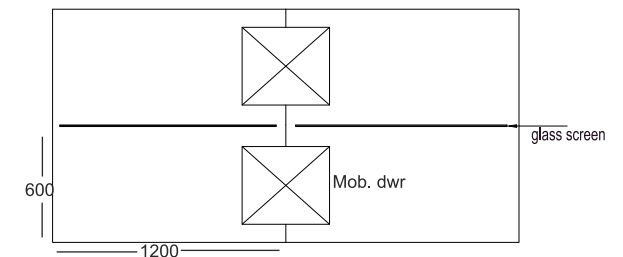

Desk - Pro 04

Back to back liner workstation
1200/1050/900 X 600mm
CRCA Powder coated under structure
CRCA Powder coated raceway
32mm/ 45mm screen/ 8 mm lacquered
glass screen
with mobile drawer
side divider glass/ partition based

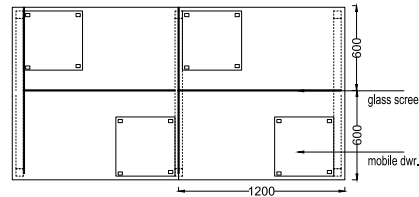

Desk - Pro 05

Back to back workstation
1200/1050/900 X 600mm
CRCA Powder coated under structure
CRCA Powder coated raceway
32mm/ 45mm screen/ 8 mm lacquered
glass screen
with mobile drawer
side divider glass/ partition based

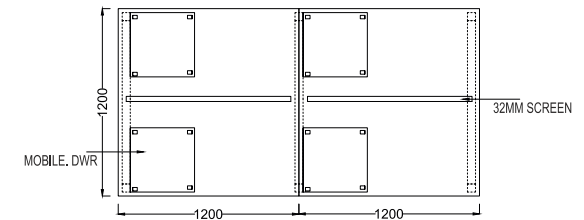

ARCHMATE®

Part - Pro 02



Back to back liner workstation
1200/1050/900 X 600mm
Aluminum Powder coated raceway
45mm/60mm screen partition with fabric / white marker board
side divider glass/ partition based

Part - Pro 01



Back to back liner workstation
1200/1050/900 X 600mm
Aluminum Powder coated raceway
45mm/60mm screen partition with fabric / white marker board with mobile drawer
side divider glass/ partition based

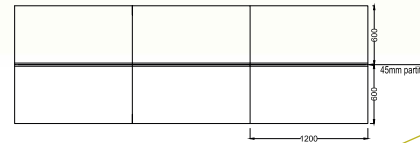
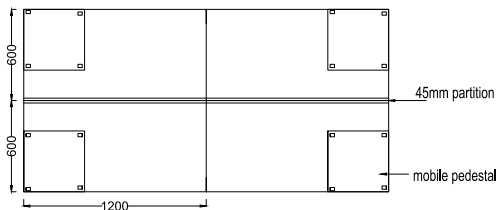

Part - Pro 03



Back to back liner workstation
1200/1050/900 X 600mm
Aluminum Powder coated raceway
45mm/60mm screen partition with fabric / white marker board
45mm/60mm side partition with mobile drawer
side divider glass/ partition based

ARCHMATE®

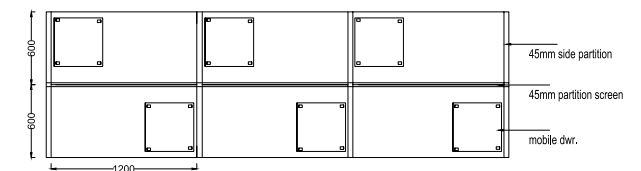

Part - Pro 04

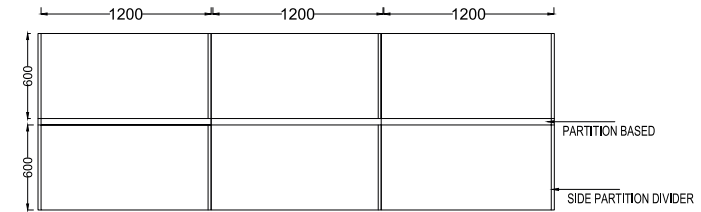

Back to back liner workstation
1200/1050/900 X 600mm
Aluminum Powder coated raceway
45mm/60mm screen partition with fabric /
white marker board
side divider glass/ partition based



ARCHMATE®

Desk-L 01

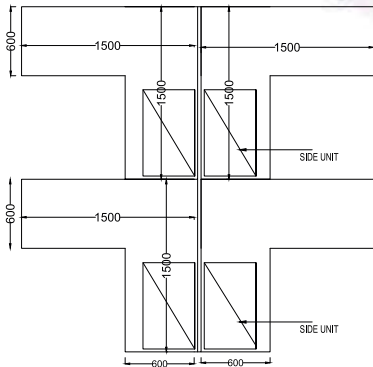

L shape workstation
 1200/1050/900 X 600mm
 CRCA Powder coated under structure
 CRCA Powder coated raceway
 32mm/ 45mm screen/ 8 mm lacquered glass
 screen
 with mobile drawer
 side divider glass/ partition based

Desk-L 02

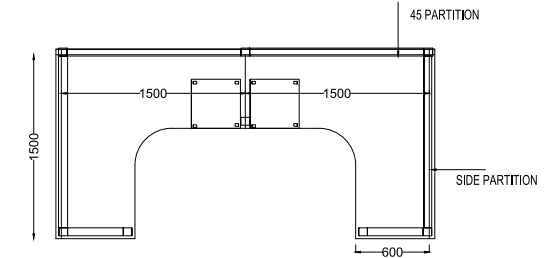

L shape workstation
 1200/1050/900 X 600mm
 CRCA Powder coated under
 structure
 CRCA Powder coated raceway
 32mm/ 45mm screen/ 8 mm
 lacquered glass screen
 with mobile drawer
 side divider glass/ partition
 based



ARCHMATE®

Desk-L 03



L shape workstation
 1200/1050/900 X 600mm
 CRCA Powder coated under structure
 CRCA Powder coated raceway
 32mm/ 45mm screen/ 8 mm lacquered glass
 screen
 with fixed mobile drawer
 side divider glass/ partition based

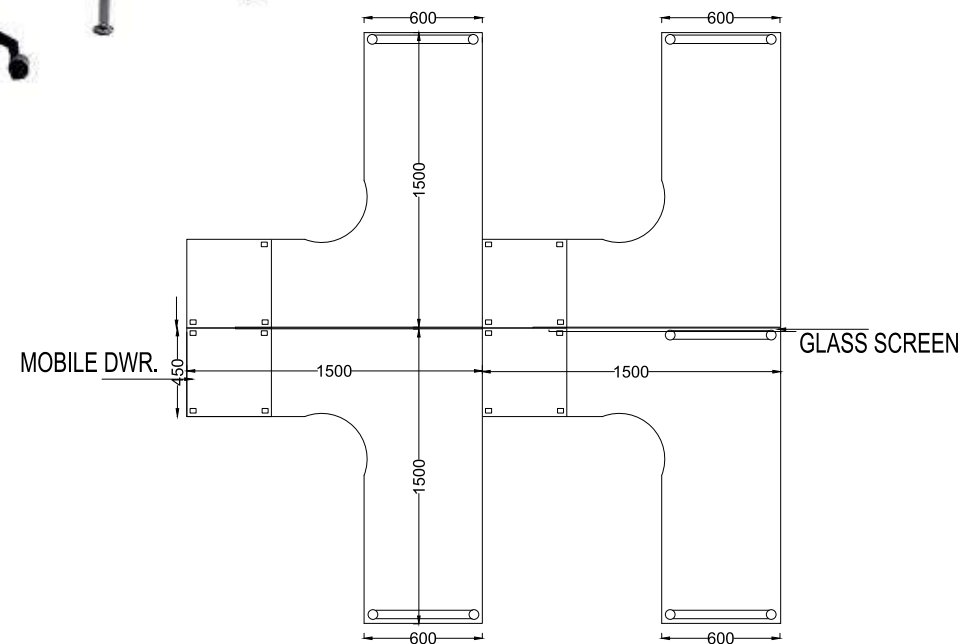

ARCHMATE®

Part L 01



L shape workstation
1200/1050/900 X 600mm
Aluminum Powder coated raceway
45mm/60mm screen partition with
fabric / white marker board
with mobile drawer
side divider glass/ partition based

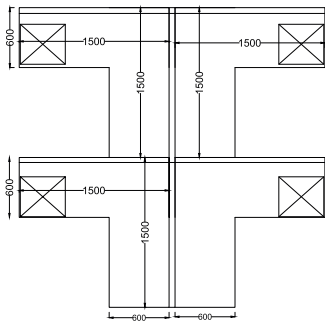

Part L 03



L shape workstation
1200/1050/900 X 600mm
Aluminum Powder coated
raceway
45mm/60mm screen
partition with fabric / white
marker board
with mobile drawer
side divider glass/ partition
based

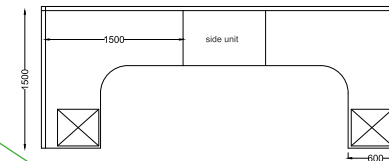

ARCHMATE®



Part L 02

L shape workstation
1200/1050/900 X 600mm
Aluminum Powder coated raceway
45mm/60mm screen partition with
fabric / white marker board
with fixed mobile drawer
side divider glass/ partition based

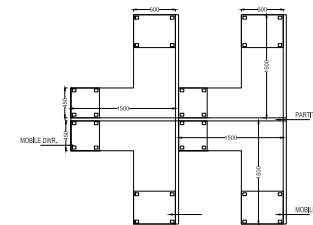

Part L 05

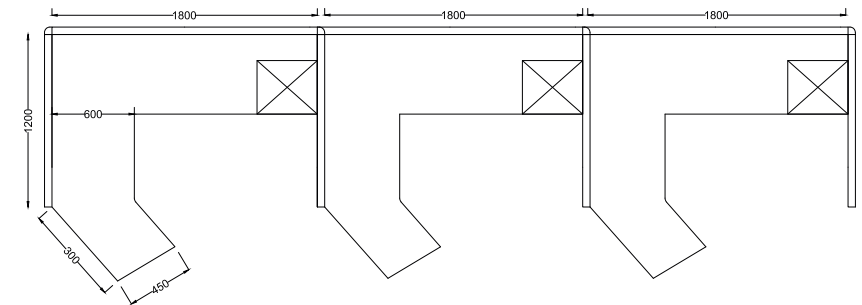

L shape workstation
 1200/1050/900 X 600mm
 Aluminum Powder coated raceway
 45mm/60mm screen partition with fabric / white marker board
 with fixed mobile drawer
 side divider glass/ partition based

ARCHMATE®

Desking Systems



120 degree workstation
 1200/1050/900 X 600mm
 CRCA Powder coated under structure
 CRCA Powder coated raceway
 32mm/ 45mm screen/ 8 mm lacquered glass screen
 with mobile drawer
 side divider glass/ partition based

Desk - Bonding 01

Partition Systems



ARCHMATE®

120 degree workstation
 1200/1050/900 X 600mm
 Aluminum Powder coated raceway
 45mm/60mm screen partition with fabric /
 white marker board
 with mobile drawer
 side divider glass/ partition based

Part - Bonding 01

Desk - Pilot 01

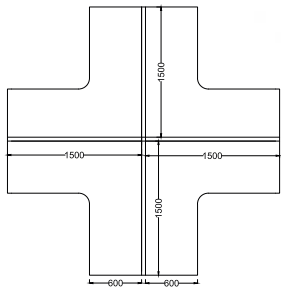

Cluster workstation
1200/1050/900 X 600mm
CRCA Powder coated under
structure
CRCA Powder coated raceway
32mm/ 45mm screen/ 8 mm
lacquered glass screen
side divider glass/ partition
based

Desk - Pilot 02

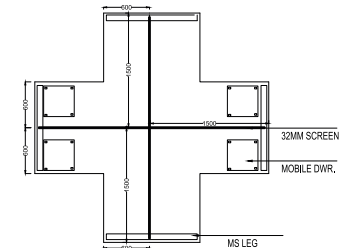

ARCHMATE®

Cluster workstation
1200/1050/900 X 600mm
CRCA Powder coated under structure
CRCA Powder coated raceway
32mm/ 45mm screen/ 8 mm lacquered
glass screen
with mobile drawer

Desk - Pilot 03

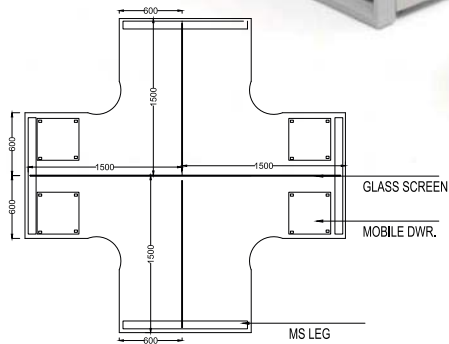

Cluster workstation
1200/1050/900 X 600mm
CRCA Powder coated
raceway
32mm/ 45mm screen/ 8 mm
lacquered glass screen
with mobile drawer
side divider glass/ partition
based

ARCHMATE®

Desk - Pilot 04

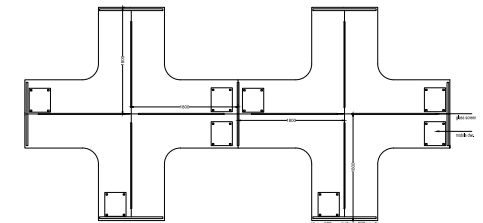

Cluster workstation
1200/1050/900 X 600mm
CRCA Powder coated raceway
32mm/ 45mm screen/ 8 mm
lacquered glass screen
with mobile drawer
side divider glass/ partition based

Part - Pilot 01

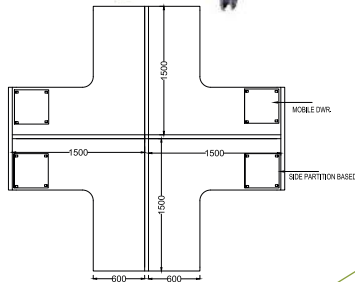

Cluster workstation
1200/1050/900 X 600mm
Aluminum Powder coated
raceway
45mm/60mm screen
partition with fabric / white
marker board
with mobile drawer
side divider glass/ partition
based

Part - Pilot 03

ARCHMATE®

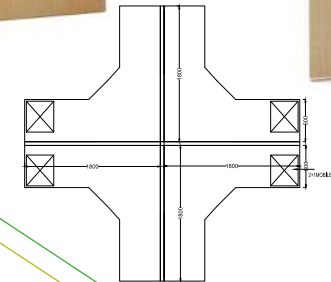

Cluster workstation
1200/1050/900 X 600mm
Aluminum Powder coated
raceway
45mm/60mm screen partition
with fabric / white marker board
with fixed 2+1 mobile drawer
side divider glass/ partition
based

Part - Pilot 02

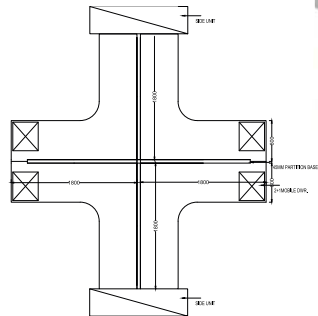

Cluster workstation
1200/1050/900 X 600mm
Aluminum Powder coated raceway
45mm/60mm screen partition with
fabric / white marker board
with 2+1 mobile drawer
with side unit
side divider glass/ partition based

Part - Pilot 04

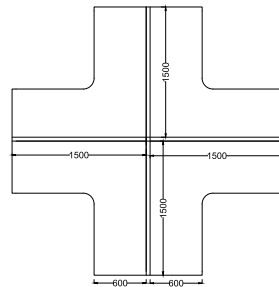

Cluster workstation
1200/1050/900 X 600mm
Aluminum Powder coated raceway
45mm/60mm screen partition with
fabric / white marker board
side divider glass/ partition based

Part - Pilot 05

ARCHMATE®

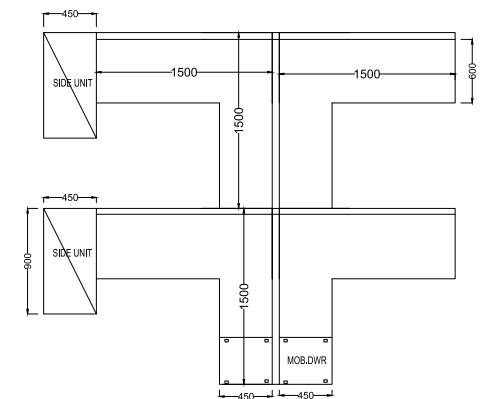

Cluster workstation
1200/1050/900 X 600mm
Aluminum Powder coated raceway
45mm/60mm screen partition with
fabric / white marker board
with mobile drawer
with side unit
side divider glass/ partition based

RECEPTION TABLE



KIIS RT 01

RECEPTION TABLE

Description

25MM Thick Top, 18MM Gable end and Modesty
Made in PLPB/ MDF/ PLY.

Dimensions/Color

As per Requirement



KIIS RT 02

RECEPTION TABLE

Description

25MM Thick Top, 18MM Gable end and Modesty
Made in PLPB/ MDF/ PLY.

Dimensions/Color

As per Requirement

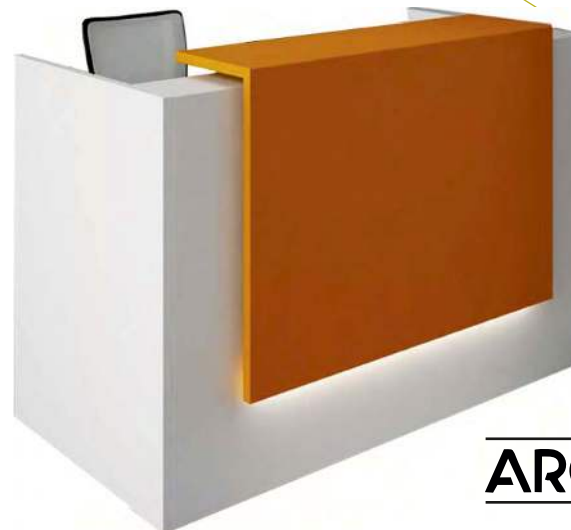

KIIS RT 03

RECEPTION TABLE

Description

25MM Thick Top, 18MM Gable end and Modesty
Made in PLPB/ MDF/ PLY.

Dimensions/Color

As per Requirement

ARCHMATE®



KIIS RT 04

RECEPTION TABLE

Description

25MM Thick Top, 18MM Gable end and Modesty
Made in PLPB/ MDF/ PLY.

Dimensions/Color

As per Requirement

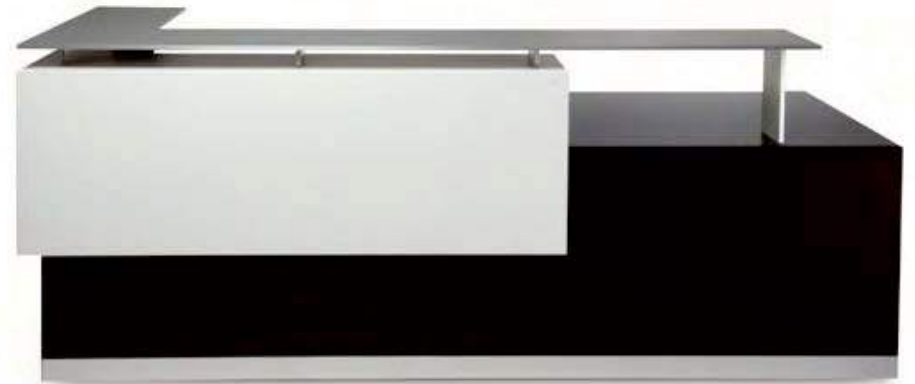

KIIS RT 05

RECEPTION TABLE

Description

25MM Thick Top, 18MM Gable end and Modesty
Made in PLPB/ MDF/ PLY.

Dimensions/Color

As per Requirement

ARCHMATE®

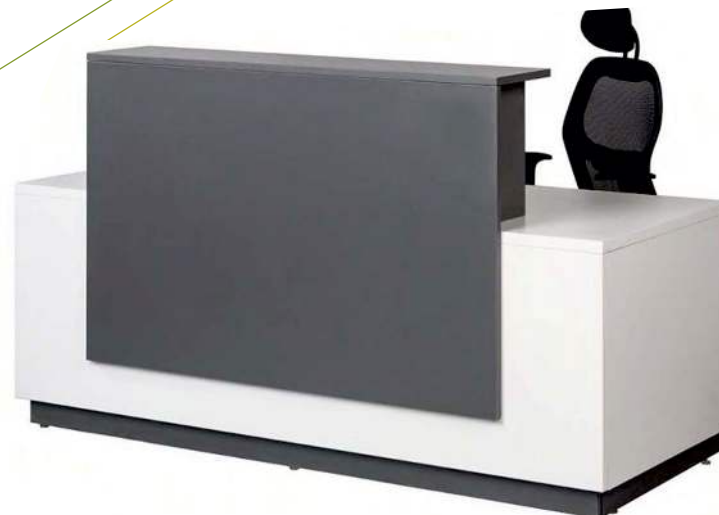

KIIS RT 06

RECEPTION TABLE

Description

25MM Thick Top, 18MM Gable end and Modesty
Made in PLPB/ MDF/ PLY.

Dimensions/Color

As per Requirement

RECEPTION TABLE



KIIS RT 07

RECEPTION TABLE

Description

25MM Thick Top, 18MM Gable end and Modesty
Made in PLPB/ MDF/ PLY.

Dimensions/Color

As per Requirement



KIIS RT 08

RECEPTION TABLE

Description

25MM Thick Top, 18MM Gable end and Modesty
Made in PLPB/ MDF/ PLY.

Dimensions/Color

As per Requirement



KIIS RT 09

RECEPTION TABLE

Description

25MM Thick Top, 18MM Gable end and Modesty
Made in PLPB/ MDF/ PLY.

Dimensions/Color

As per Requirement

ARCHMATE®

MODULAR OFFICE TABLE



KIIS OT 01

OFFICE TABLE

Description

25MM Thick Top, 18MM Gable end and Modesty
Made in PLPB/ MDF/ PLY.

Dimensions/Color

As per Requirement



KIIS OT 02

OFFICE TABLE

Description

25MM Thick Top, 18MM Gable end and Modesty
Made in PLPB/ MDF/ PLY.

Dimensions/Color

As per Requirement

KIIS OT 03

OFFICE TABLE

Description

25MM Thick Top, 18MM Gable end and Modesty
Made in PLPB/ MDF/ PLY.

Dimensions/Color

As per Requirement



ARCHMATE®

ARCHMATE®



KIIS OT 04

OFFICE TABLE

Description

25MM Thick Top, 18MM Gable end and Modesty
Made in PLPB/ MDF/ PLY.

Dimensions/Color

As per Requirement



KIIS OT 05

OFFICE TABLE

Description

25MM Thick Top, 18MM Gable end and Modesty
Made in PLPB/ MDF/ PLY.

Dimensions/Color

As per Requirement



KIIS OT 06

OFFICE TABLE

Description

25MM Thick Top, 18MM Gable end and Modesty
Made in PLPB/ MDF/ PLY.

Dimensions/Color

As per Requirement

MODULAR OFFICE TABLE

ARCHMATE®



KIIS OT 07

OFFICE TABLE

Description

25MM Thick Top, 18MM Gable end and Modesty
Made in PLPB/ MDF/ PLY.

Dimensions/Color

As per Requirement



HED-05

available sizes:
over all size (Main Table)
• 1500 x 1650 x 750 (1500 x 750)
• 1800 x 1650 x 750 (1800 x 750)

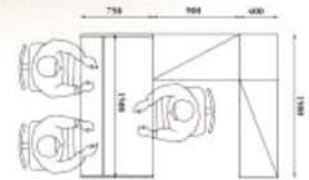

KIIS OT 08

OFFICE TABLE

Description

25MM Thick Top, 18MM Gable end and Modesty
Made in PLPB/ MDF/ PLY.

Dimensions/Color

As per Requirement



HED-04

available sizes:
over all size (Main Table)
• 1500 x 1650 x 750 (1500 x 750)
• 1800 x 1650 x 750 (1800 x 750)

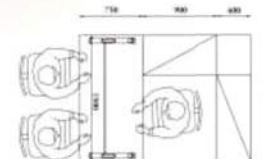

KIIS OT 09

OFFICE TABLE

Description

25MM Thick Top, 18MM Gable end and Modesty
Made in PLPB/ MDF/ PLY.

Dimensions/Color

As per Requirement

MODULAR OFFICE TABLE

Smart



HED-02

available sizes:
over all size (Main Table)
• 1500 x 1650 x 750 (1500 x 750)
• 1800 x 1650 x 750 (1800 x 750)

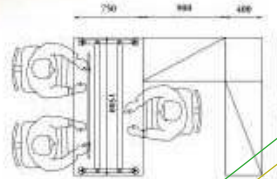

KIIS OT 10

OFFICE TABLE

Description

25MM Thick Top, 18MM Gable end and Modesty
Made in PLPB/ MDF/ PLY.

Dimensions/Color

As per Requirement



KIIS OT 11

OFFICE TABLE

Description

25MM Thick Top, 18MM Gable end and Modesty
Made in PLPB/ MDF/ PLY.

Dimensions/Color

As per Requirement



HED-01

available sizes:
over all size (Main Table)
• 1500 x 1650 x 750 (1500 x 750)
• 1800 x 1650 x 750 (1800 x 750)

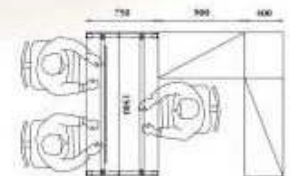

KIIS OT 12

OFFICE TABLE

Description

25MM Thick Top, 18MM Gable end and Modesty
Made in PLPB/ MDF/ PLY.

Dimensions/Color

As per Requirement

ARCHMATE®



KIIS CT 01

CONFERENCE TABLE

Description

25MM Thick Top, 18MM Gable end and Modesty
Made in PLPB/ MDF/ PLY.

Dimensions/Color

As per Requirement



ARCHMATE®

KIIS CT 02

CONFERENCE TABLE

Description

25MM Thick Top, 18MM Gable end and Modesty
Made in PLPB/ MDF/ PLY.

Dimensions/Color

As per Requirement



KIIS CT 03

CONFERENCE TABLE

Description

25MM Thick Top, 18MM Gable end and Modesty
Made in PLPB/ MDF/ PLY.

Dimensions/Color

As per Requirement

CONFERENCE TABLE



KIIS CT 04

CONFERENCE TABLE

Description

25MM Thick Top, 18MM Gable end and Modesty
Made in PLPB/ MDF/ PLY.

Dimensions/Color

As per Requirement



KIIS CT 05

CONFERENCE TABLE

Description

25MM Thick Top, 18MM Gable end and Modesty
Made in PLPB/ MDF/ PLY.

Dimensions/Color

As per Requirement

ARCHMATE®



KIIS CT 06

CONFERENCE TABLE

Description

25MM Thick Top, 18MM Gable end and Modesty
Made in PLPB/ MDF/ PLY.

Dimensions/Color

As per Requirement

CONFERENCE TABLE

ARCHMATE®

KIIS CT 07

CONFERENCE TABLE

Description

25MM Thick Top, Powder coated leg,
Made in PLPB/ MDF/ PLY.

Dimensions/Color

As per Requirement



KIIS CT 08

CONFERENCE TABLE

Description

Made in MarbleTop & CRC powder coating leg.

Dimensions/Color

As per Requirement



SMALL MEETING TABLE



KIIS MT 01

SMALL MEETING TABLE

Description

25MM Thick Top, 18MM Gable end and Modesty
Made in PLPB/ MDF/ PLY.

Dimensions/Color

As per Requirement



KIIS MT 02

SMALL MEETING TABLE

Description

25MM Thick Top, 18MM Gable end and Modesty
Made in PLPB/ MDF/ PLY.

Dimensions/Color

As per Requirement

ARCHMATE®



KIIS MT 03

SMALL MEETING TABLE

Description

25MM Thick Top, 18MM Gable end and Modesty
Made in PLPB/ MDF/ PLY.

Dimensions/Color

As per Requirement

SMALL MEETING TABLE



KIIS MT 04

SMALL MEETING TABLE

Description

25MM Thick Top, 18MM Gable end and Modesty
Made in PLPB/ MDF/ PLY.

Dimensions/Color

As per Requirement



KIIS MT 05

SMALL MEETING TABLE

Description

25MM Thick Top, 18MM Gable end and Modesty
Made in PLPB/ MDF/ PLY.

Dimensions/Color

As per Requirement

ARCHMATE®



KIIS MT 06

SMALL MEETING TABLE

Description

25MM Thick Top, 18MM Gable end and Modesty
Made in PLPB/ MDF/ PLY.

Dimensions/Color

As per Requirement



KIIS BS 01



KIIS BS 02



KIIS BS 03



KIIS BS 04



KIIS BS 05



KIIS BS 06



KIIS SD 01



KIIS SD 02



KIIS SD 03



KIIS SD 04



KIIS SD 05



KIIS SD 06

Product Specifications

Partition Frames



Specially extruded aluminium frames 52/30mm with 9mm thick snapfit tiles.



PARTITION MATRIX

HEIGHT	WIDTH					
	450	600	750	900	1050	1200
900*	✓	✓	✓	✓	✓	✓
1175	✓	✓	✓	✓	✓	✓
1325*	✓	✓	✓	✓	✓	✓
1635	✓	✓	✓	✓	✓	✓
2095	✓	✓	✓	✓	✓	✓
2555	✓	✓	✓	✓	✓	✓

* requires special tile height
✓ indicates available

Wiremanagement

Wire management has a powerful function of crossline laying of vertical and horizontal wiring. Module lay on cable management system allows assemblage of wires and division of power, communication and data cables. You have the freedom to specify power only where you need it. It also enables immediate reconfiguration which saves significant installation cost and time.

Height Option Chart

1175

Maintains the open feeling, but makes the desktop a bit more private, which enhances work efficiency.

1635

High enough to surround office equipment. That makes the office look neat and cuts down on noise. With this height you can choose from a range of hanging units to add filing space.

2095

Suitable for creating executive areas and meeting rooms. Gives the sense of being in an entirely individual room, yet see through panel grids can be used to oversee operations in other areas.

2555

An alternative to constructing an actual wall to separate different divisions or departments. This gives you the maximum degree of privacy a panel can provide. Doors can be added at this height.



5 ELEMENTS Library of Options

Markerboard Tiles

Heights: 8", 16", 24", 32"
Widths: 18", 24", 30", 36", 42", 48", 54", 60"

Slat Tiles

Heights: 8", 16"
Widths: 18", 24", 30", 36", 42", 48", 54", 60"

Steel Tiles

Heights: 8", 16", 24", 32"
Widths: 18", 24", 30", 36", 42", 48", 54", 60"

Laminate, Wood & Fabric/Tackable Tiles

Heights: 8", 16", 24", 32", 40", 48", 56", 64", 72"
Widths: 18", 24", 30", 36", 42", 48", 54", 60"

Technology Tiles (Laminate, Wood, Fabric or Slat)

Heights: 16", 32"
Widths: 24", 30", 36", 42", 48", 54", 60"

Clear & Patterned Glass Stack Frame

Heights: 16", 24"
Widths: 18", 24", 30", 36", 42", 48", 54", 60", 66", 72", 78", 84", 90", 96"

Stack Frame

Heights: 16"
Widths: 18", 24", 30", 36", 42", 48", 54", 60"

Sliding Door

Panel frame heights listed below correspond to tile heights that are two inches shorter

Frame

Heights: 34", 42", 50", 58", 66", 74"
Widths: 18", 24", 30", 36", 42", 48", 54", 60"

Clear & Patterned Glass Panel

Available with or without 8" raceway cover
Heights: 42", 50", 58", 66", 74"
Widths: 18", 24", 30", 36", 42", 48"

ARCHMATE®

Product Specifications

Desking System

Wire management



A Inwards of wire through openable metal cover.

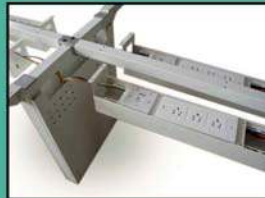

B Distribution of wire to cable tray.

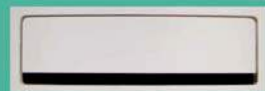

Brush Flap

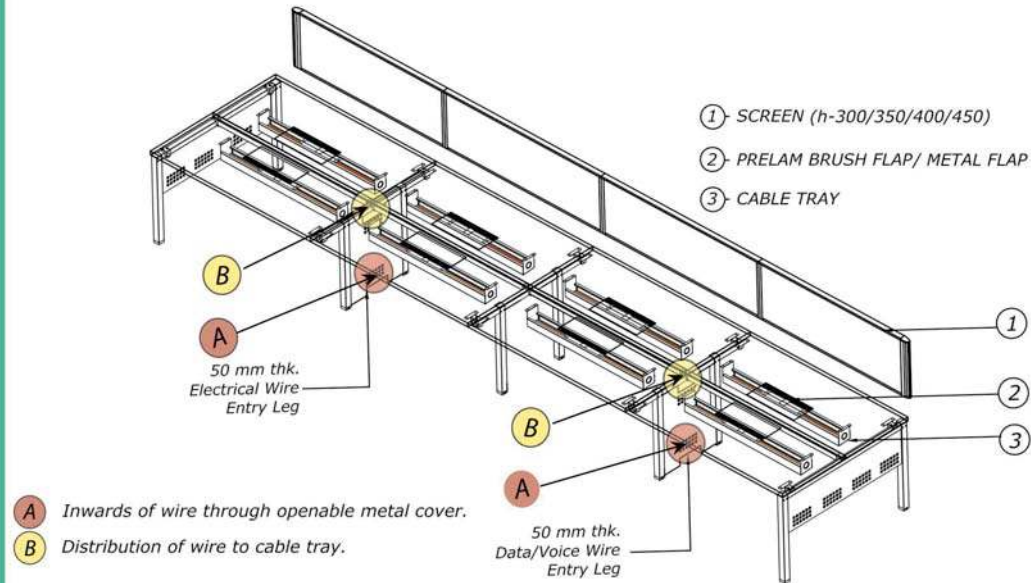

MAIN FRAME

SHARED WORKSTATION



W x H
1650 x 725
1500 x 725
1400 x 725
1250 x 725



W x H
500 x 725

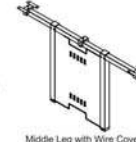

NON - SHARED WORKSTATION



W x H
800 x 725
750 x 725
700 x 725
600 x 725



W x H
270 x 725



CONNECTING BAR



as per top size



OPTIONAL WIRE ENTRY GUIDE



W X D X H
100X150X800

WIRE ACCESSORIES

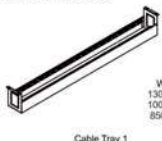

W X D X H
1300X100X120
1000X100X120
850X100X120



W X D
360X150
510X150
600X150

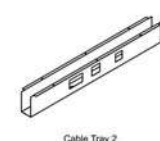

W X D X H
1300X650X120
1000X650X120
850X650X120

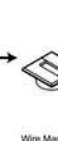

SCREENS OPTION

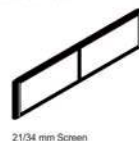

W X H
1500X450
1200X450
1050X450



W X H
1200X450
900X450
750X450



W X H
1400X600
1000X600

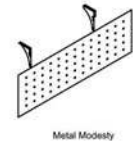

W X H
1500X450
1200X450
900X450

PVB GLASS SCREEN ALSO AVAILABLE

ARCHMATE®

Storages

Space saving aesthetically designed storage solutions that fit the modern workplace, helping you manage gadgets and documents. Overhead storages for standing height access, mobile pedestals for arms length access. Open shelves and sliding shutter cabinets. Desktop cabinets roller shutter door cabinets, and credenzas. Storages come in a varying range of size and colour options.



Handle Options

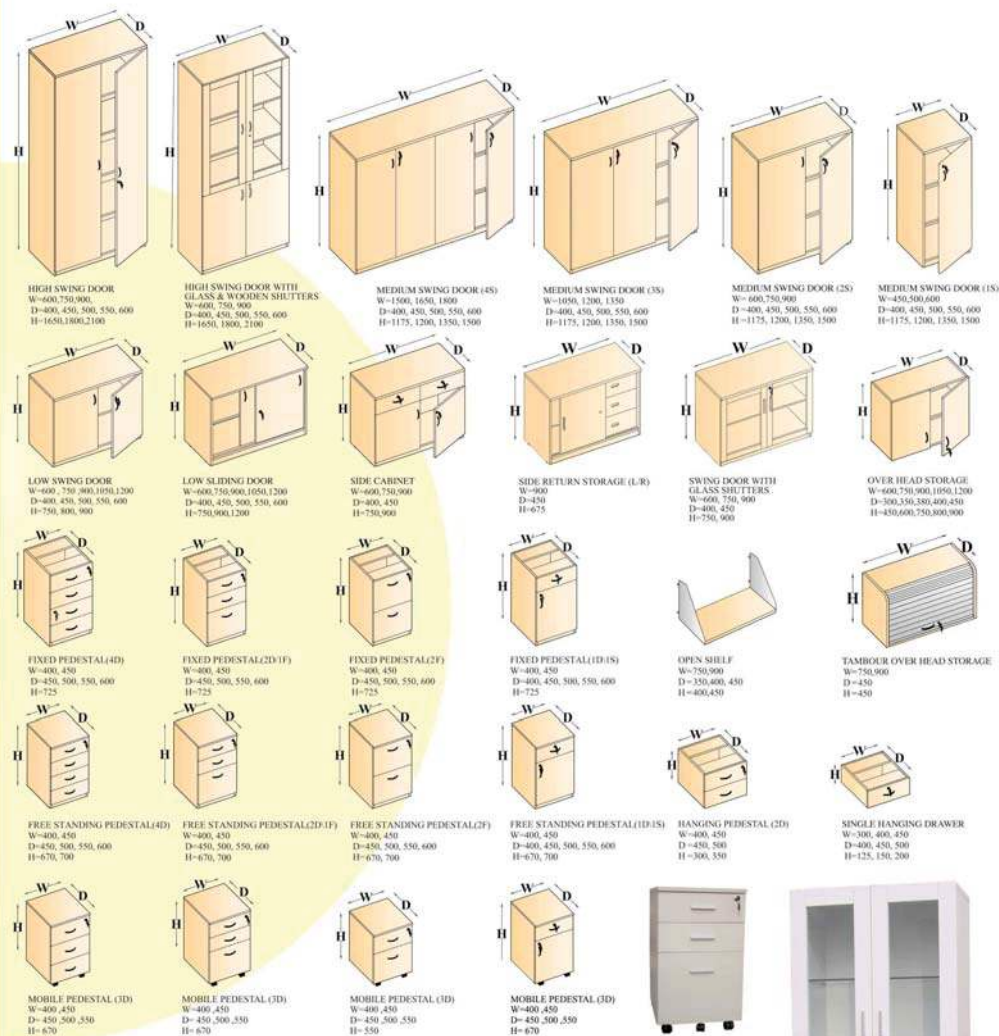

All dimensions are in mm.

Development is a continuous process at HARMONY SYSTEMS, therefore we reserve the right to change the design and specification without prior notice and obligation. All our standard products come with regular handles. In case you require premium handles, prices will be charged extra as applicable.

Product Specifications

Table Tops

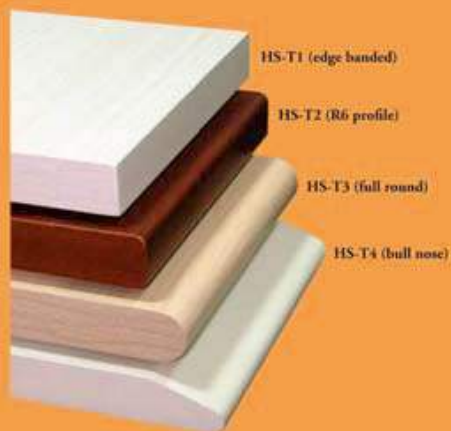
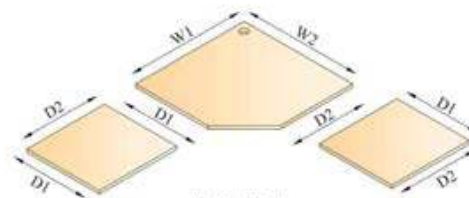

Table Top Options



RECTANGULAR TOP
W1=1050,1200,1350,1500,1800
D1=450,500,600,750,900



PENTAGON TOP
W1=900,1050
W2=900,1050
D1=450,500,600,750
D2=450,500,600,750



CABIN TOP (TYPE-2)
W1=600,750,900,1050
W2=1200,1350,1500,1650,1800
W3=1200,1350,1500,1650,1800
D1=600,750,900
D2=450,500,600



CALL CENTER TOP (TYPE-1)
W1=1050,1200,1350,1500,1800
D1=450,500,600,750,900
D2=500,600,750,900,1050



CURVILINEAR TOP (TYPE-1)
W1=1500,1650,1800
W2=1500,1650,1800
D1=500,600,750
D2=500,600,750

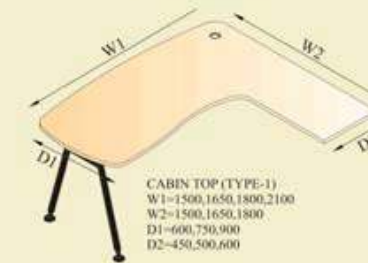

CABIN TOP (TYPE-1)
W1=1500,1650,1800,2100
W2=1500,1650,1800
D1=600,750,900
D2=450,500,600

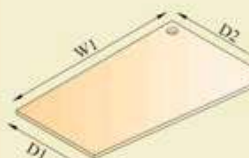

CALL CENTER TOP (TYPE-2)
W1=1050,1200,1350,1500,1800
D1=450,500,600,750,900
D2=500,600,750,900,1050

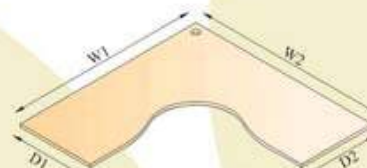

CURVILINEAR TOP (TYPE-2)
W1=1500,1650,1800
W2=1500,1650,1800
D1=500,600,750
D2=500,600,750



CABIN TOP (TYPE-3)
W1=1200,1350,1500,1650,1800
W2=1200,1350,1500,1650
D1=600,750,900,1050
D2=450,500,600,750

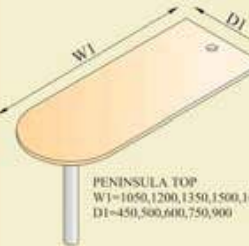

PENINSULA TOP
W1=1050,1200,1350,1500,1650,1800
D1=450,500,600,750,900



CURVILINEAR TOP (TYPE-3)
W1=1200,1350,1500,1650,1800
W2=1200,1350,1500,1650,1800
D1=450,500,600,750
D2=450,500,600,750

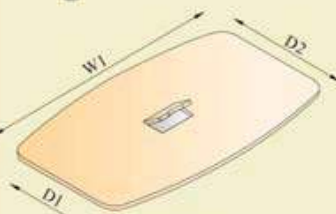

CONFERENCE TABLE
W1=1200,1350,1500,1800,2100,2400
D1=750,900,1050,1200,1350,1500
D2=900,1050,1200,1350

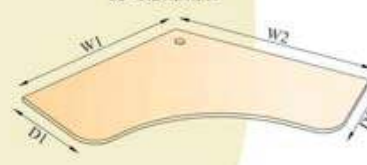

120° CURVILINEAR TOP
W1=1050,1200,1350,1500
W2=1050,1200,1350,1500
D1=450,500,600,750
D2=450,500,600,750

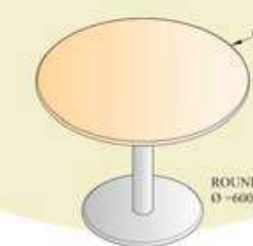

ROUND TABLE
Ø=600,750,900,1050,1200



HALF ROUND TOP
Ø=600,750,900,1050,1200,1500

ARCHMATE®

ADVANTAGE - ARCHMATE®



Completely accessible wire management



Choose from variety of trim profile and finishes, with a wide range of fabric suiting to the synergy of space

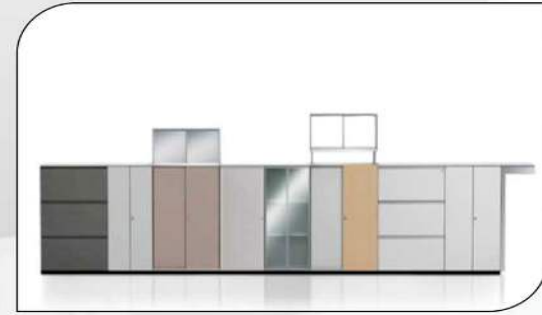

Panels can be custom fixed for you to create storage space of size and shape you want

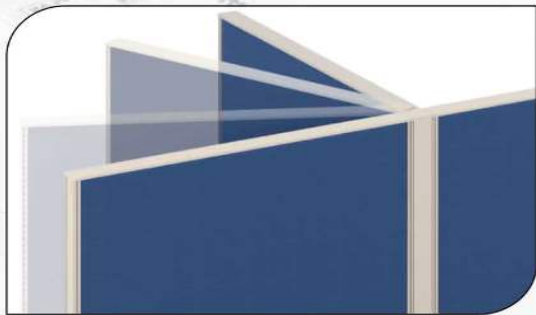

The exposed edges of the frames with rounded aluminum frames defining overall aesthetics



Option of race way to be kept on table top or beneath table



Ergonomic curvilinear surface design makes a more friendly and effective work system



Fully mobile pedestal storage for work and personal storage needs equipped with lock



Workstation mounted accessories allow for enhanced space utilization e.g. file and pen holder, paper tray etc

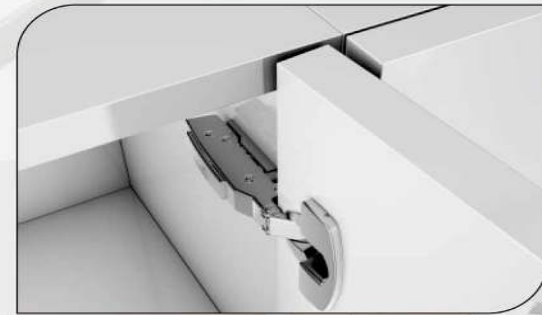

High quality hardware ensuring life long durability and hence hassle free working

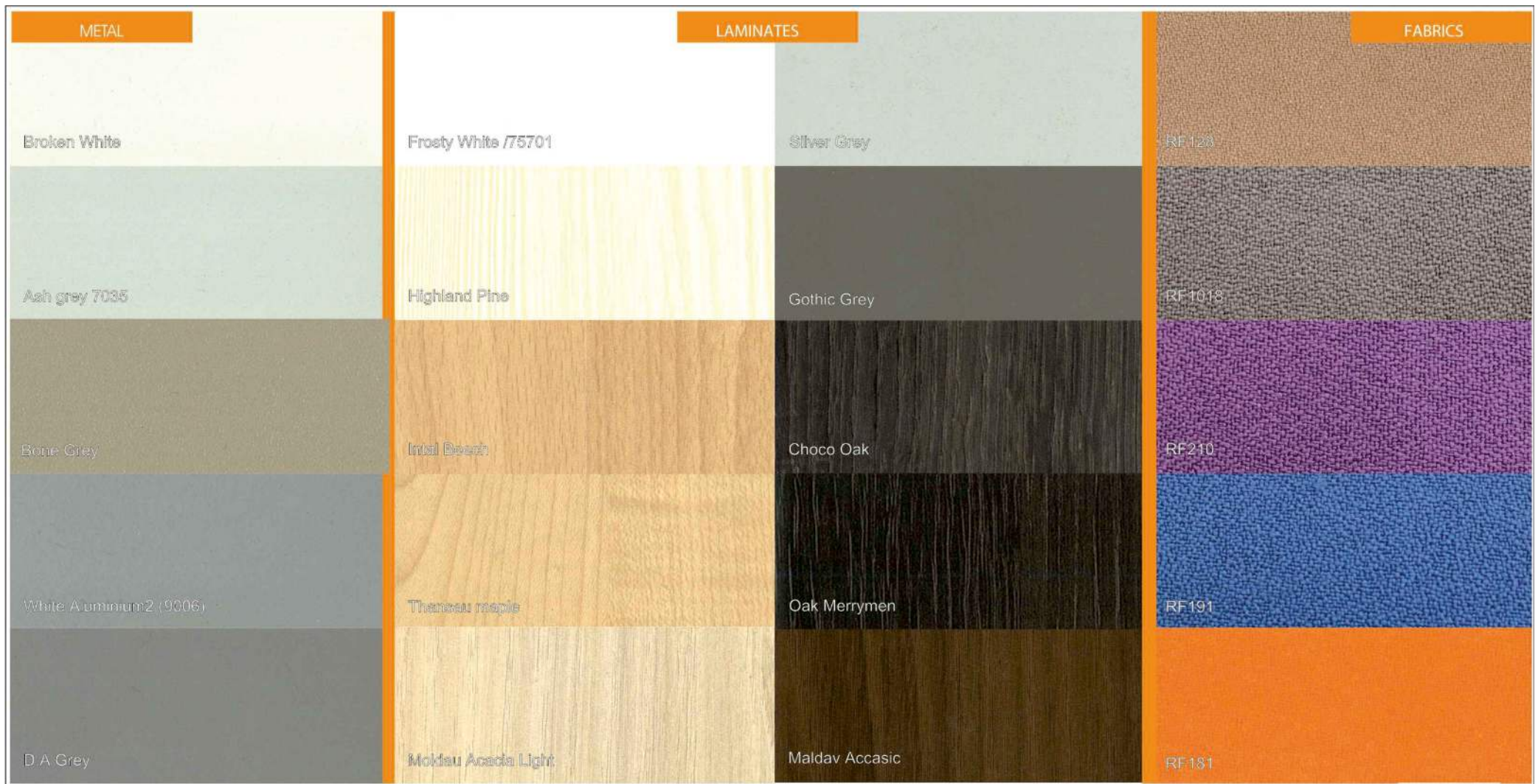

- ❑ **ARCHMATE** Systems is a leading designer and manufacturer of ergonomic office furniture such as workstation, cabin furniture, conference table, cafe tables, chairs, metal storage, systems and full height glass partition system. Our systematic work approach, ingenious product range, in house inventive development capabilities, quality products, fast services and after sales support have kept us in the leading position in the office furniture industry.
- ❑ Creating positivity in workplace with simple elegance is the hallmark of **ARCHMATE** systems. We provide fully integrated systems that enhance your corporate image and work efficiency . Our modular workstation design enables them to be configured to suit any mood or interior.
- ❑ Our goal is to create the perfect working environment with a constant endeavour towards innovation and perfection.
- ❑ Latest CMC machinery is used for panel and sheet metal working as cutting-edge technology for precision & accuracy to ensure impeccable finish.
- ❑ In business since 2014, we have designed and manufactured customer specific products and changed the conventional definition of workspace from boredom to joyful work. Our comprehensive service is a driving force for customer satisfaction and we offer our best capabilities to meet all customer demands. **ARCHMATE** systems is an ISO 9001:2008, ISO 14001:2004 & ISO 18001:2007 specified company and quality is strictly controlled under ISO 9001:2008, ISO 14001:2004 & ISO 18001:2007 standards. Latest CMC Manufacturing capabilities go a long way in producing international quality products that we proudly produce.
- ❑ At **ARCHMATE** Systems, we have incredible technical and professional resources with complete control on screening and sorting of raw material and innovation on design to create distinctive and apt office environment.
- ❑ Our constant endeavour is towards perfection and innovation so as to surpass customer satisfaction. Our customer needs and meeting their timely requirement is the key to our success.

CNC BEAM SAW EB-120 ACTIVE



Cutting large quantity of panels is done on this fine piece of machine imported from M/s BIESSE, Italy. The panels are cut in exact dimensions as required through an optimisation software.

SLIDING TABLE PANEL SAW



These machines are used to cut the wooden panels in exact dimensions as provided. The final panels produced have a perfect 90 degree cut.

THROUGH FEED EDGE-BANDING



We have world leading Ergho5 from M/s BIESSE Italy. It allows the application of edge-banding material in rolls and strips from 0.4mm to 15mm thickness. It can be customized to any edge-banding requirement.

MANUAL EDGE BANDING MACHINE



Curvi linear Edge banding is done on FRAVOLA16S. It can produce straight, rounded or curved panels. It permits the application of Veneer, Melamine, PVC and ABS edges up to 3mm thick and solid wood edges up to 4mm.

CNC MACHINING CENTRE



CNC Machining is done on Rover 22 manufactured by M/s BIESSE Italy. This machine can produce any shapes drawn on the drawing and can drill on the system 32 drilling pattern.

POSTFORMING



Post forming is done on this fully PLC controlled machine. It has better work piece holding due to uniform pressure. It is fully automatic PLC controlled machine resulting in perfectly finished pieces of postformed panels.

ARCHMATE[®]

Our Esteemed Clients...

ARCHMATE®



Cipla



LODHA



LIVSPACE

& Many More...



Procter&Gamble

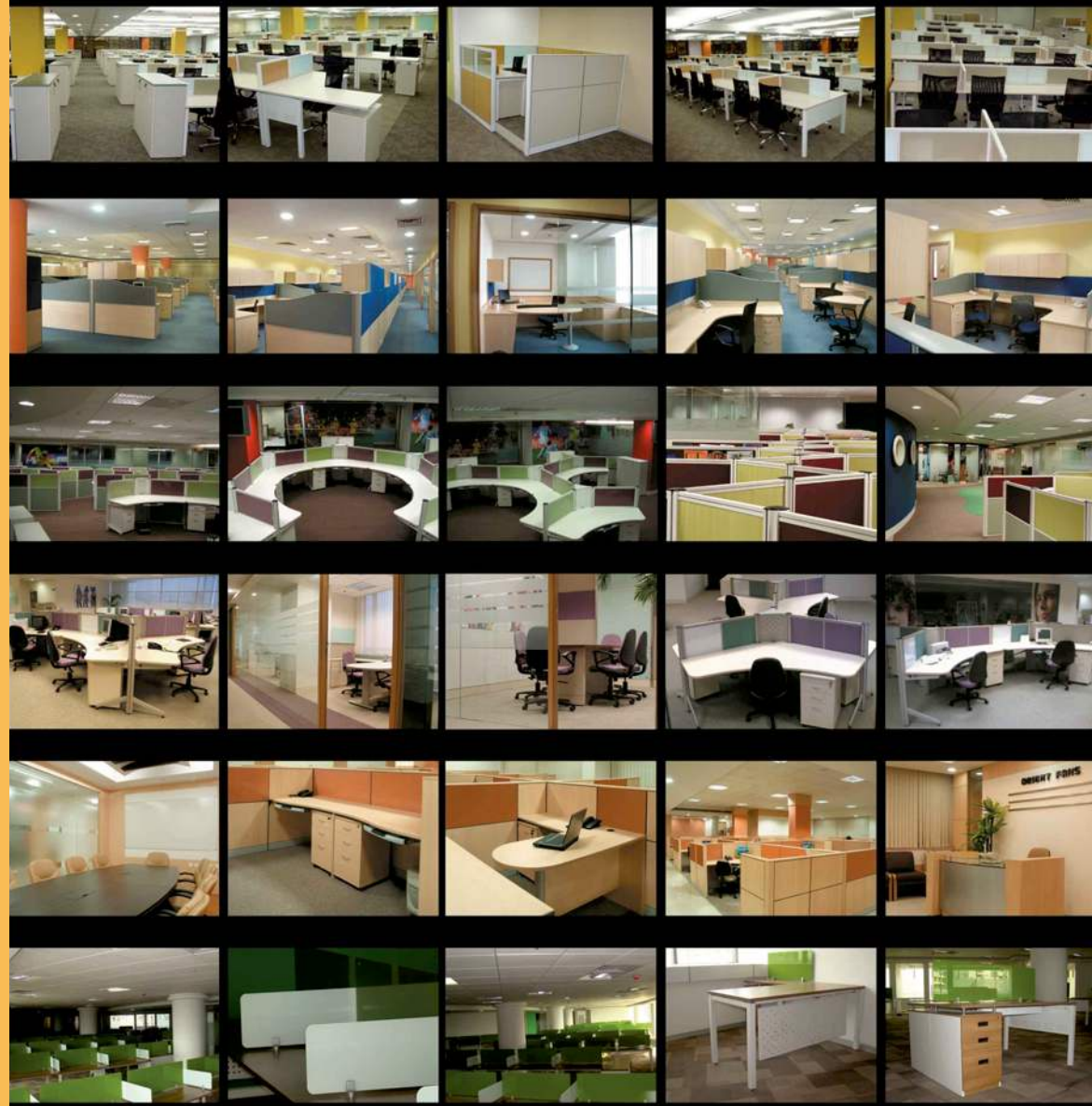



Other Services:



We also serve as an effective partner with Architectural Firms, Interior Designers, Commercial Real Estate Companies, Corporate, Builders and Developers to help them accomplish projects with our value added services and products. Our goal is to help our partners achieve their bottom line of cost, quality and time-line and create a win-win situation of shared values.

We have a strong team to cater to all kinds of infrastructure works with strong determination and taking appropriate decisions on site basis their rich experience.



YOUR PARTNER IN LUXURIOUS CREATIONS



KAIZEN INNOVE INTERIOR SOLUTIONS LLP

4th Floor, North Bdg, NESCO, Goregaon, Mumbai -63

 www.archmate.in  contact@archmate.in

 +91 84528 91863 / 74000 92837 / 99588 80991

GST-27AAPFK1511RIZU